

# PROJECT INFORMATION

Project Date: December 2009

Sebastiano del Piombo  
"Pietà"  
"Flagellazione"



## Reconstruction of the display cases for the paintings "Pietà" and "Flagellazione" by Sebastiano del Piombo

### The design

The design of the new display cases for the paintings by Sebastiano del Piombo is based on a study focused on two main criteria:

1. to preserve the paintings within cases that fulfill the role of protecting the works from damage due to both mechanical events and microclimatic variations;
2. to respect the exhibition conceived by the architect and museographer Franco Minissi.

The existing cases consist of a metal framework rising from ground level and supported by an element fastened to the floor. The upper parts of the frames are secured to sections fastened to a tubular metal structure fashioned as a groin vault. The paintings are inserted within the frames and secured with brackets and by a 10 cm plexiglass frame.

### The concept

The concept was to utilize the existing structures and to add outer shell elements made of innovative materials. This gave origin to the "Crystal Boxes," made of invisible, anti-glare methacrylate and acrylic material.

The same material was utilized to make the "Climaboxes" for twelve drawings by Leonardo da Vinci and for his "Codex on the Flight of Birds" (held by Turin's Royal Library) for the travelling exhibition in the USA; it was also used for a painting on wood by Beato Angelico (held by the Vatican Museum) for an exhibition in Japan.

### The intervention

The Crystal Boxes are made of an invisible acrylic sheet with white methacrylate edges and are inserted inside the metal structure of the existing frames. The works are mounted following the criteria already adopted in the earlier exhibition.

## Sebastiano del Piombo "Pietà" e "Flagellazione"

The microclimatic conditions are controlled through miniaturized, high precision data loggers located outside the cases, but fitted with one-meter-long probes. The relative humidity is stabilized with a packet of pre-conditioned ProSorb.



During the coming twelve months, a careful analysis of the temperature and humidity conditions within the cases and in the exhibition rooms will be conducted, in order to assess possible equipment additions.

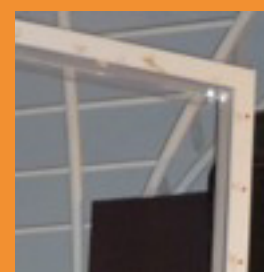
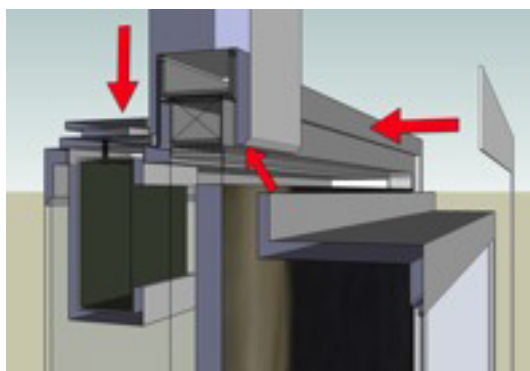

**Sebastiano del Piombo "Pietà" e "Flagellazione"**

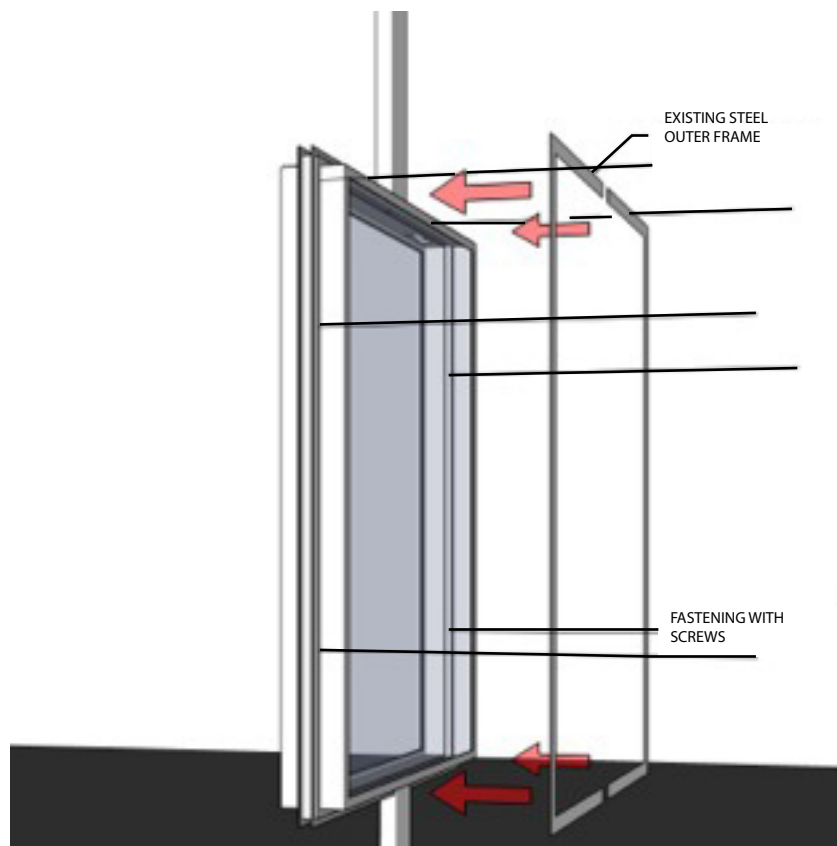
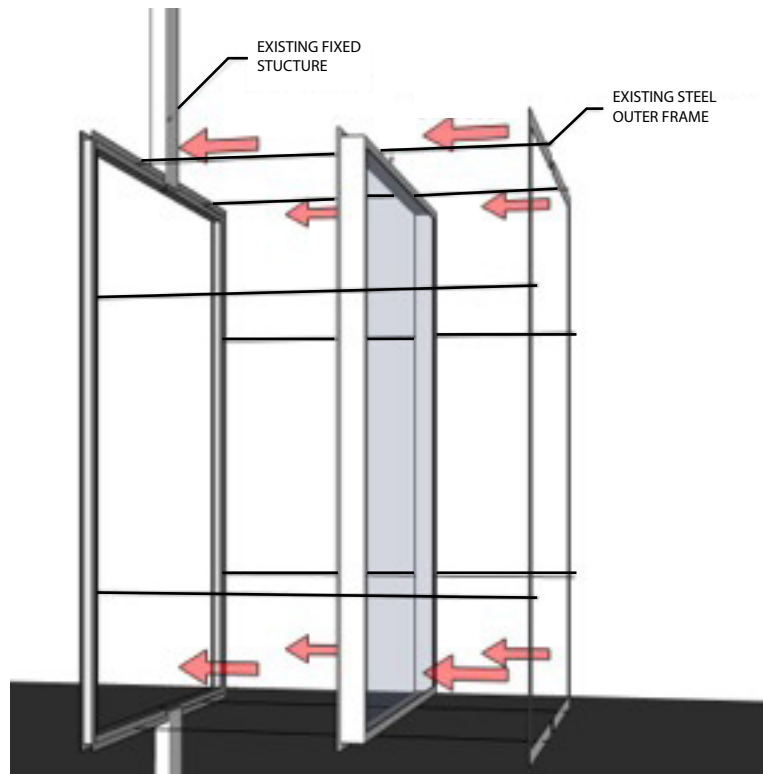

**Sebastiano del Piombo "Pietà" e "Flagellazione"**

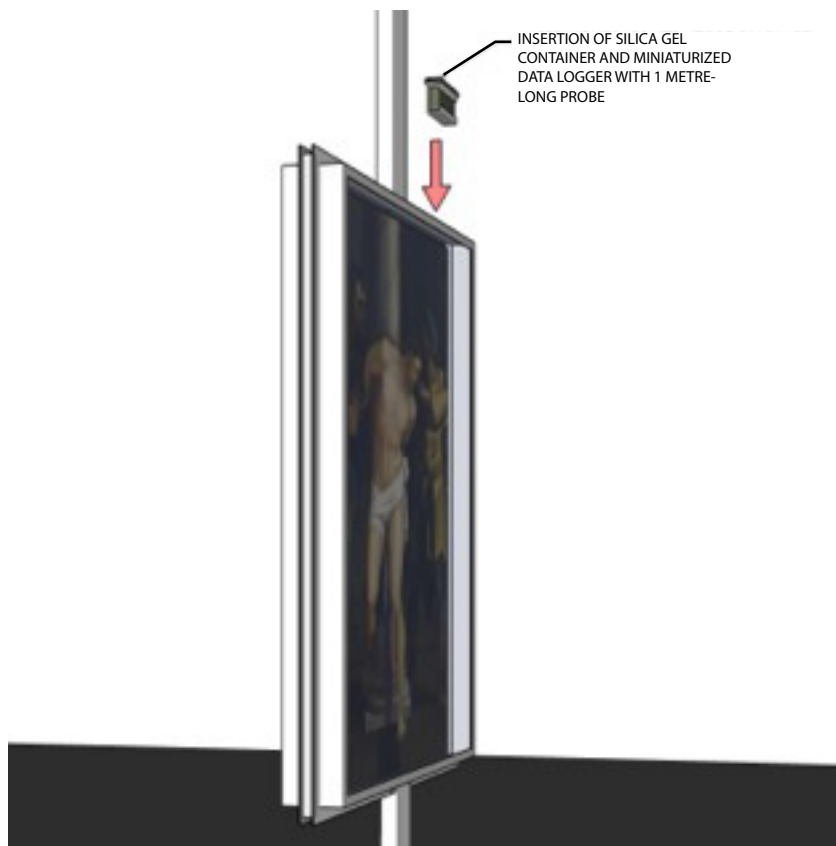
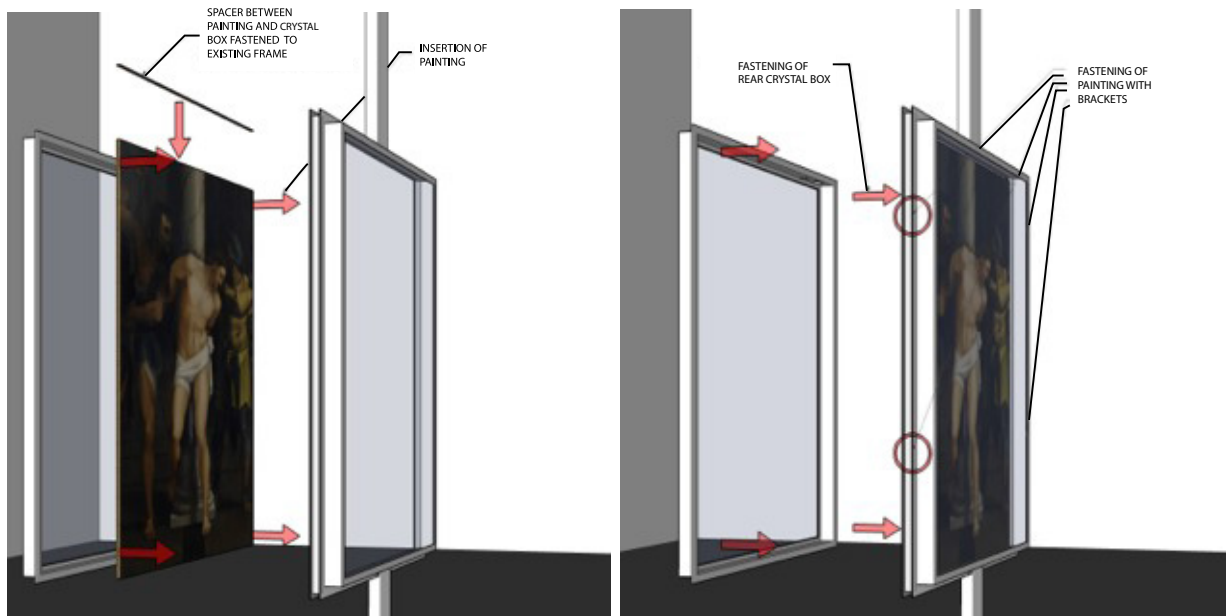

**Sebastiano del Piombo "Pietà" e "Flagellazione"**



Collaborators:

Luca Poleggi - Michele Arcaese - Marcello Matarrocci - Siro Balio



*Ivano Francavilla*

The company Ivano Francavilla is engaged in the development, design, production and distribution of technical products that, with innovative design and high technological content, offer solutions for museum environments and restoration laboratories.

Ivano Francavilla is a trusted supplier of major institutions such as the Vatican Museums, the Presidency of the Italian Republic, the Senate and the Galleria d'Arte Moderna in Rome, the Galleria dell'Accademia and l'Opificio delle Pietre Dure in Florence, and countless other Italian museums.

This article is intended for educational purposes only and does not replace independent professional judgment. Statements of fact and opinions expressed are those of the author(s) individually and, unless expressly stated to the contrary, are not the opinion or position of Tru Vue or its employees. Tru Vue does not endorse or approve, and assumes no responsibility for, the content, accuracy or completeness of the information presented.